

HP-2 Indirect Starter/Independent Installation Instructions

Scan QR code for helpful video(s)

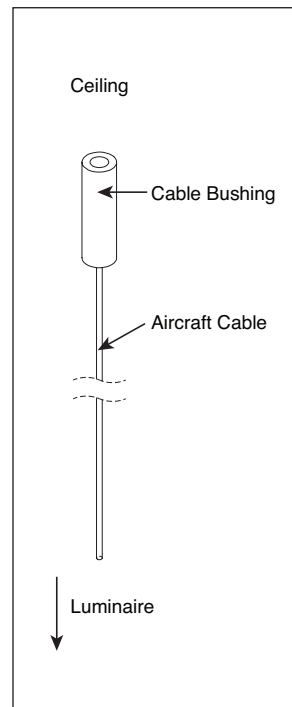

0 - 10V Dimming



Locate aircraft cables.

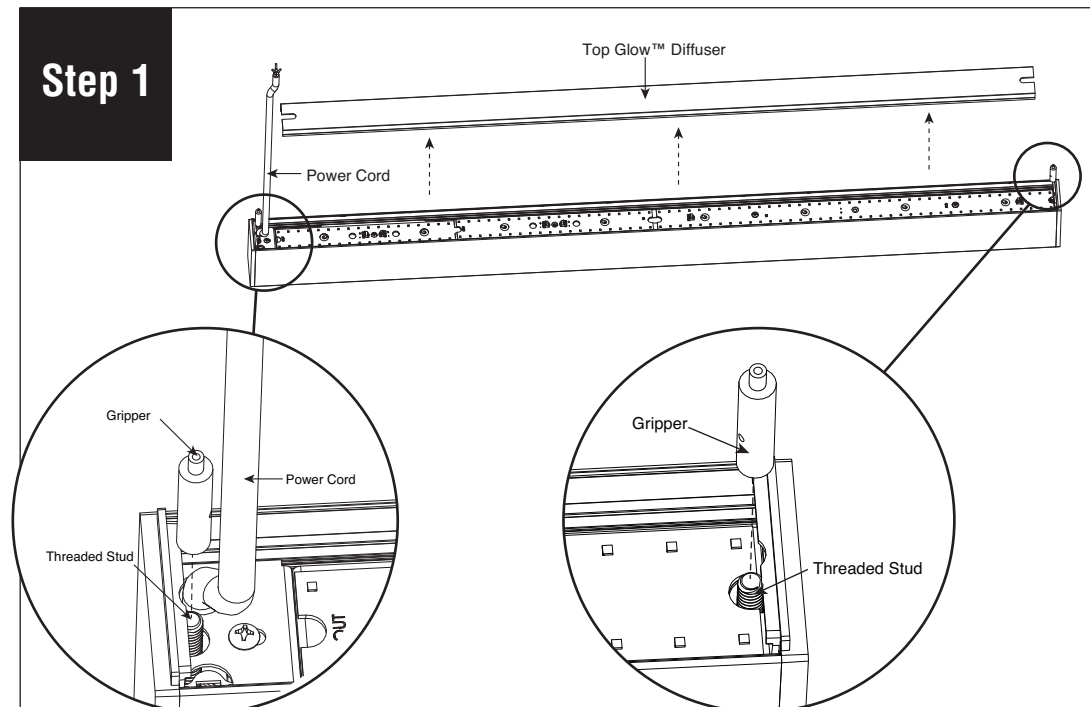

Remove Top Glow™ diffuser and set aside. Install grippers onto threaded studs on both ends of the luminaire.

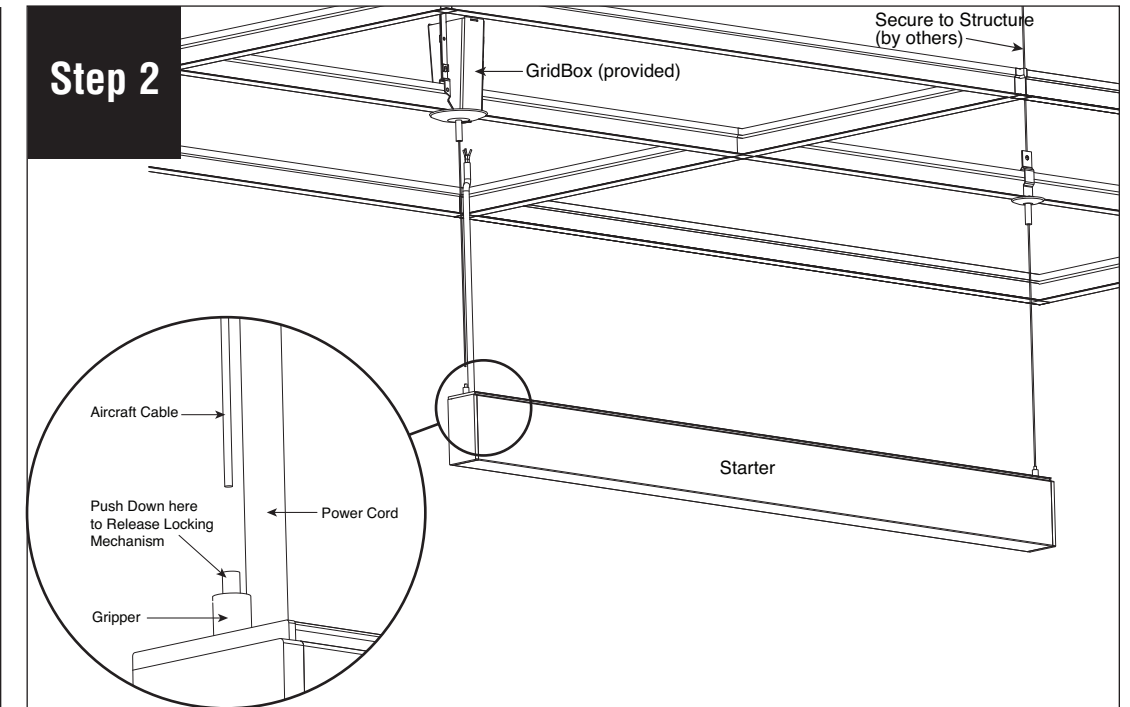

Align aircraft cables to grippers and insert on both ends of the luminaire. Adjust pendant to proper height and level. Press down on top of gripper to release locking mechanism if needed. Secure luminaire to structure using tie-wire (by others) according to code.

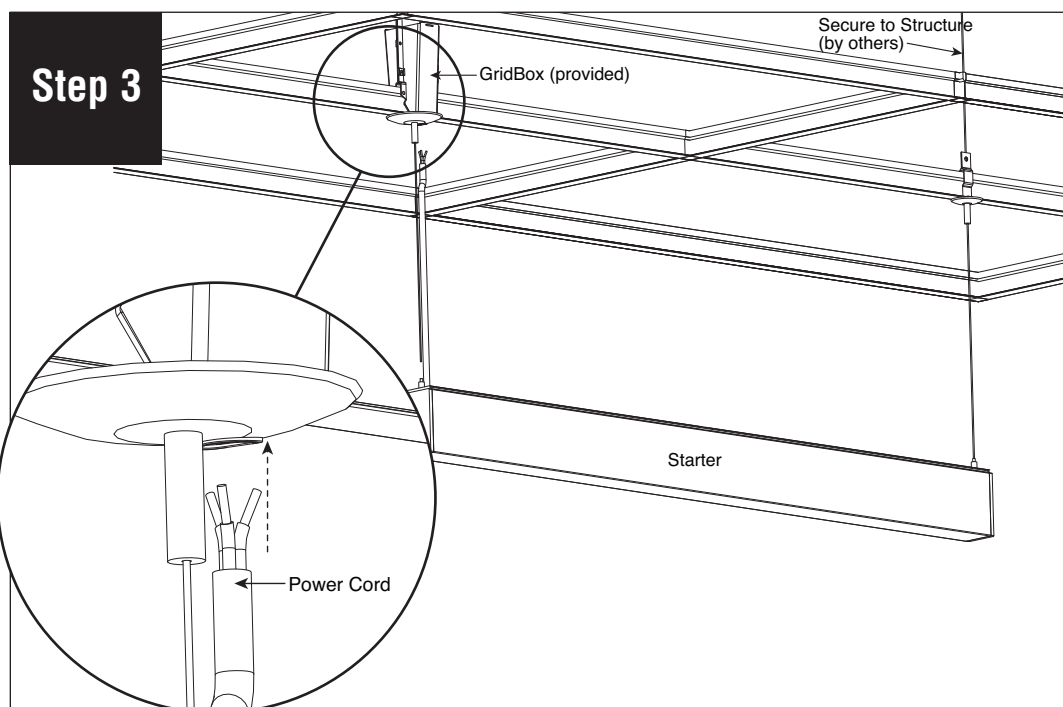

Install power cable through canopy and into GridBox™. Make electrical connections in GridBox.

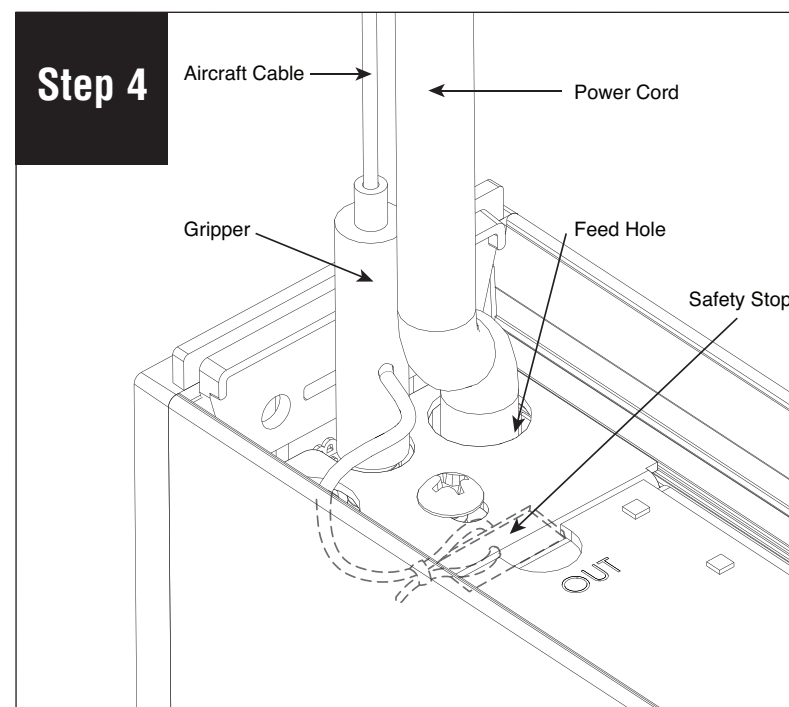

Slide safety stop and safety crimp up to the aircraft cable within 9" of cable gripper. Trim excess cable and insert safety bar assembly through feed hole.

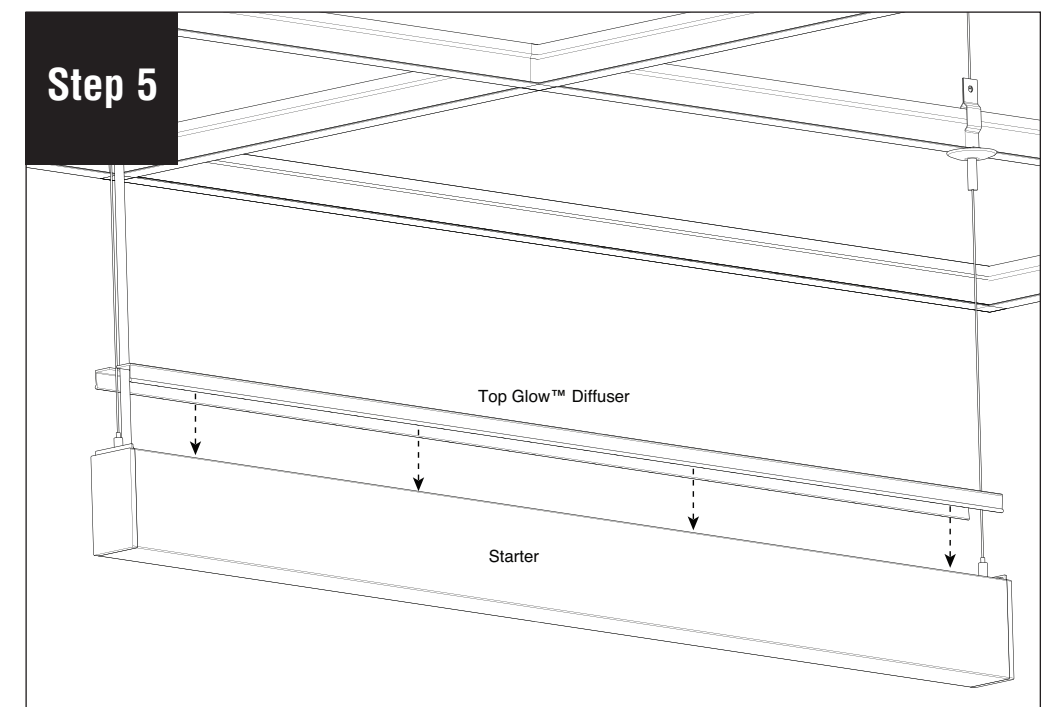

Reinstall Top Glow diffuser and diffuser end caps. Turn power on to luminaire.

Note: All power connections to be installed to local/national codes by a Certified Electrician.

HP-2 Indirect Joiner/Ender Installation Instructions

Scan QR code for helpful video(s)



0 - 10V Dimming

Step 1

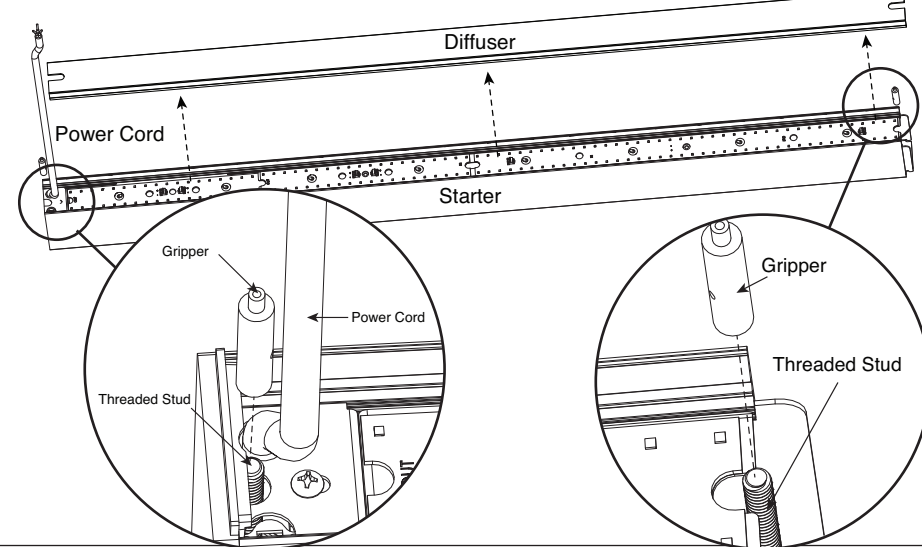

Remove Top Glow diffuser of starter and joiner/ender and set aside. Install grippers onto threaded studs on both ends of the starter. Repeat steps for joiner/ender.

Step 2

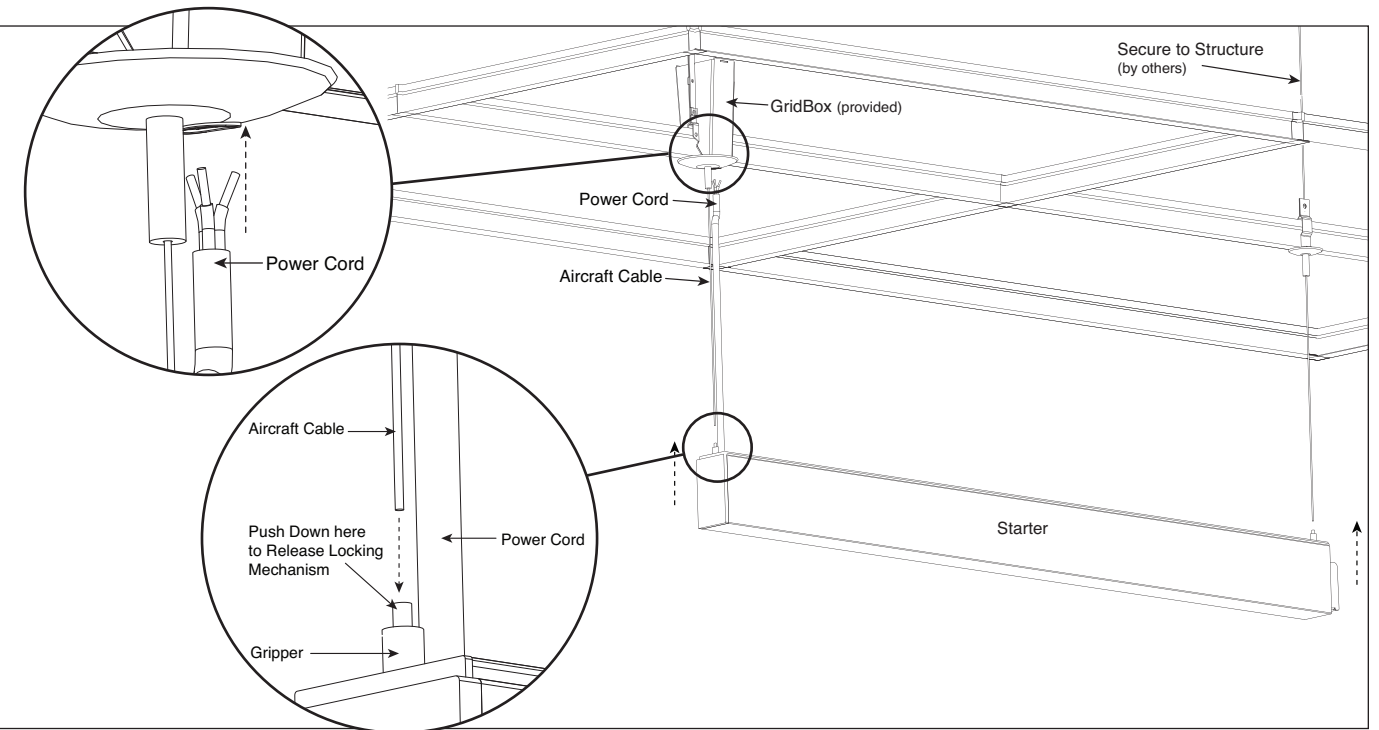

Install aircraft cables into grippers and adjust luminaire to proper height and level. Insert power cable into canopy then into GridBox™. Press down on top of gripper to release locking mechanism if needed. Secure luminaire to structure using tie wire (by others) according to code.

Step 3

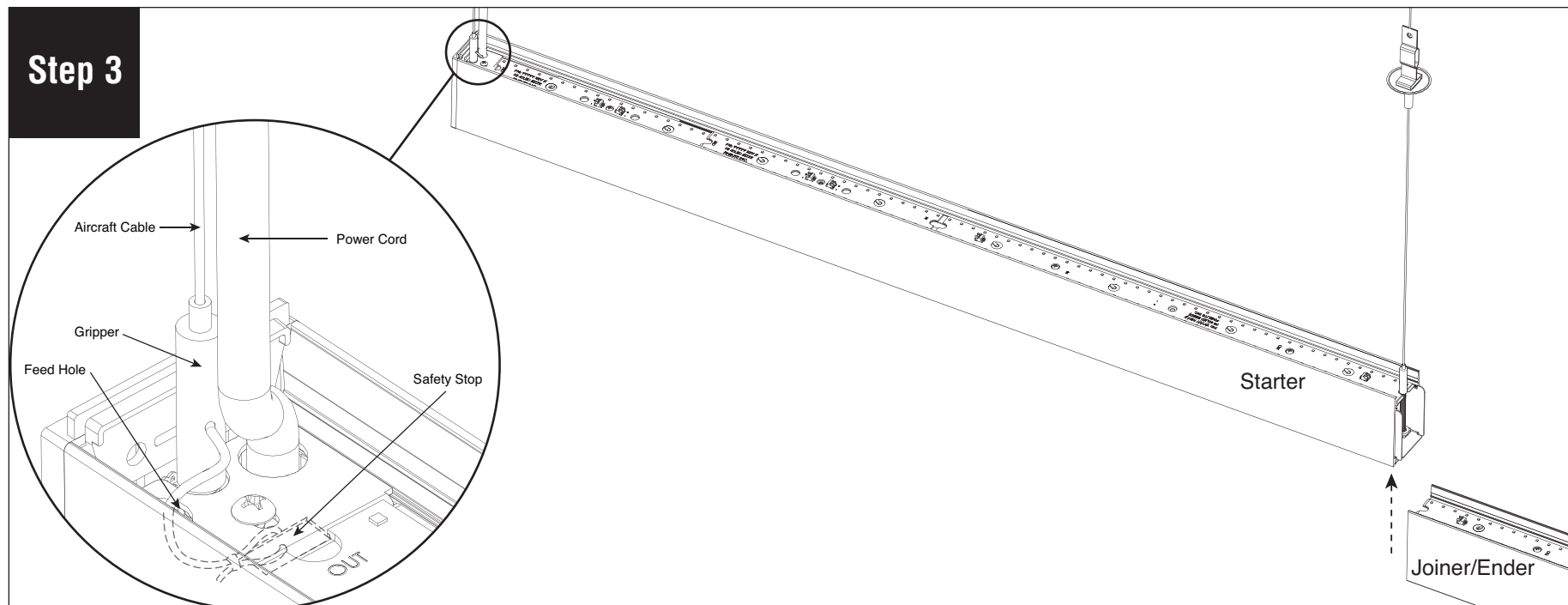

Slide safety stop and safety crimp up to the aircraft cable within 9" of cable gripper. Trim excess cable and insert safety bar assembly through feed hole (apply to starter and joiner(s)/ender).

Step 4

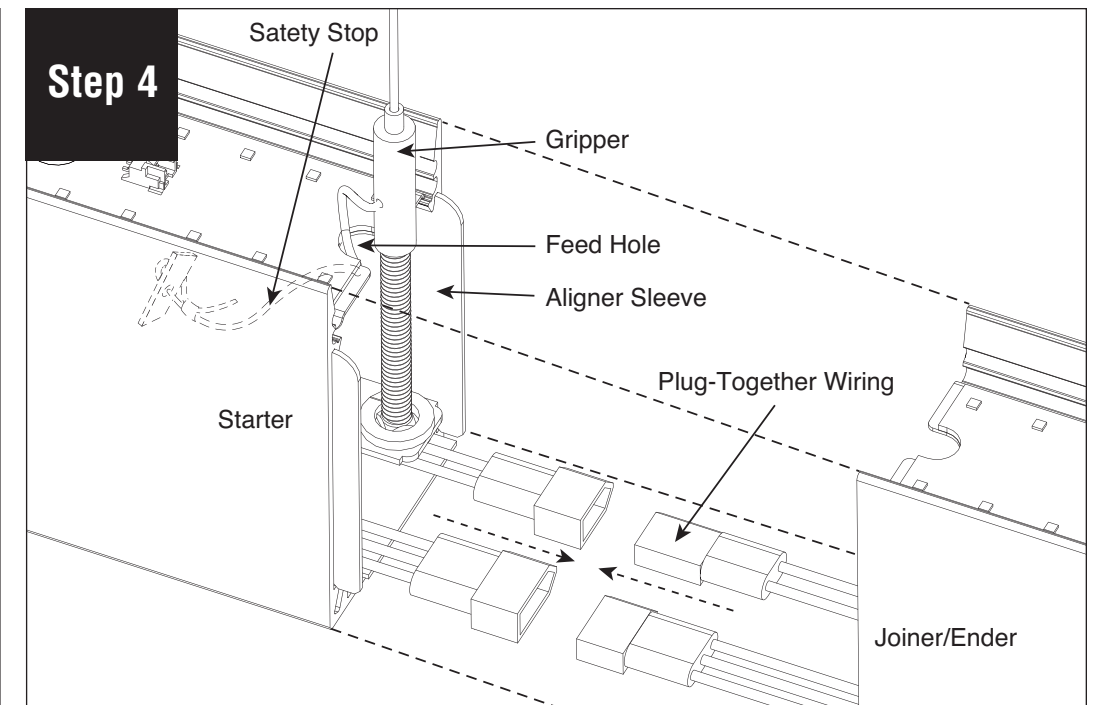

Connect plug-together wiring. Align joiner/ender with aligner sleeve, then slide starter and joiner/ender together. Be careful not to damage wiring.

Note: All power connections to be installed to local/national codes by a Certified Electrician.

HP-2 Indirect Joiner/Ender Installation Instructions

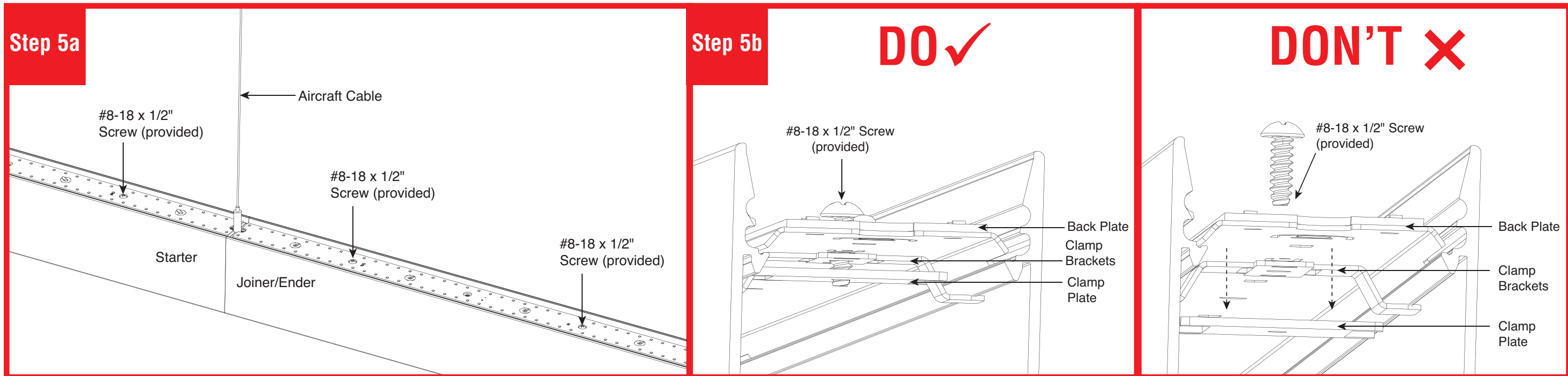

A. Locate #8-18 x 1/2" screws (provided) for removal of back plate (Note: there may be several along the length of the array).

B. Loosen #8-18 x 1/2" screws (provided) about 3X revolutions from back plate assemblies.

DO NOT loosen too much so that clamp plate fall off. If they do, just reinstall them to the underside of the back plate.

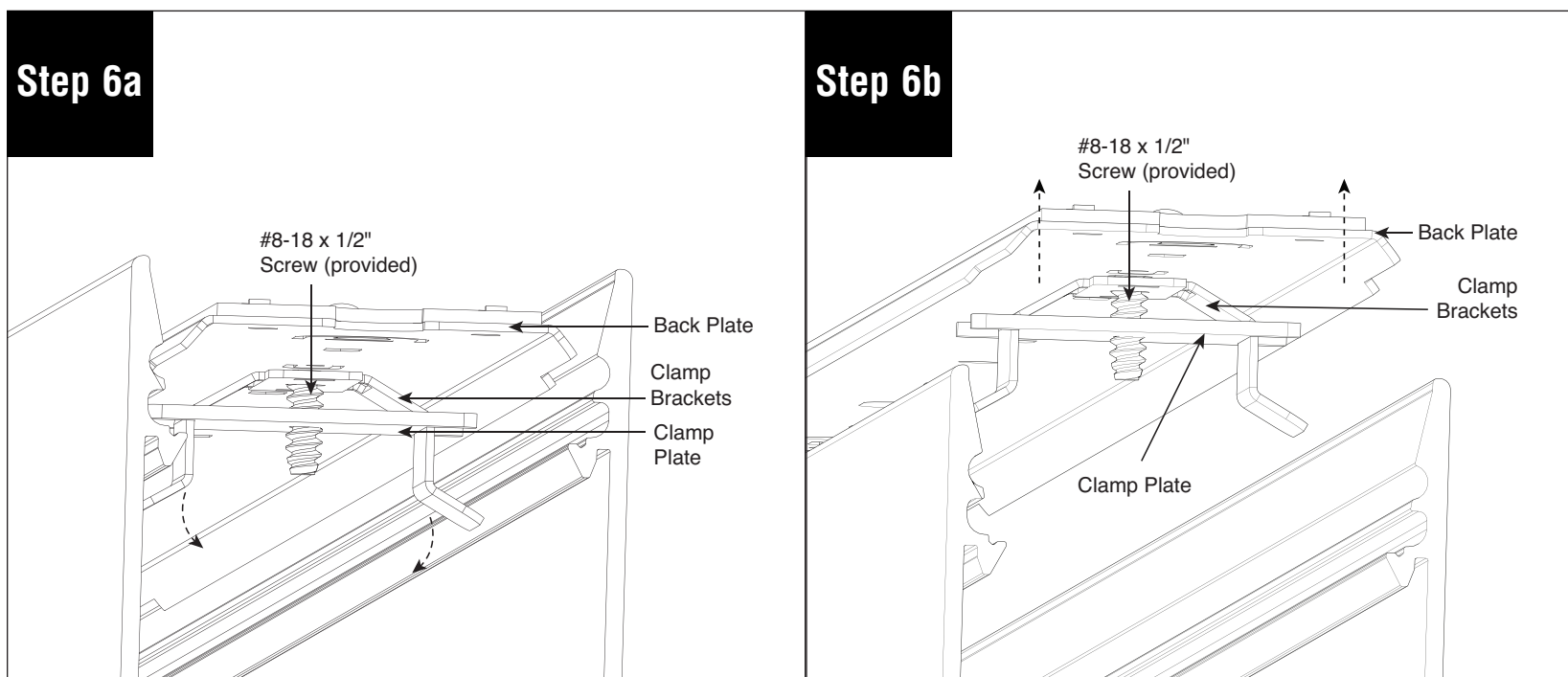

A. Lift backplate until clamp brackets fold and release from body. If they still won't release, loosen the #8-18 x 1/2" screw (provided) one more revolution and try again.

B. Lift and remove back plate assembly and set aside.

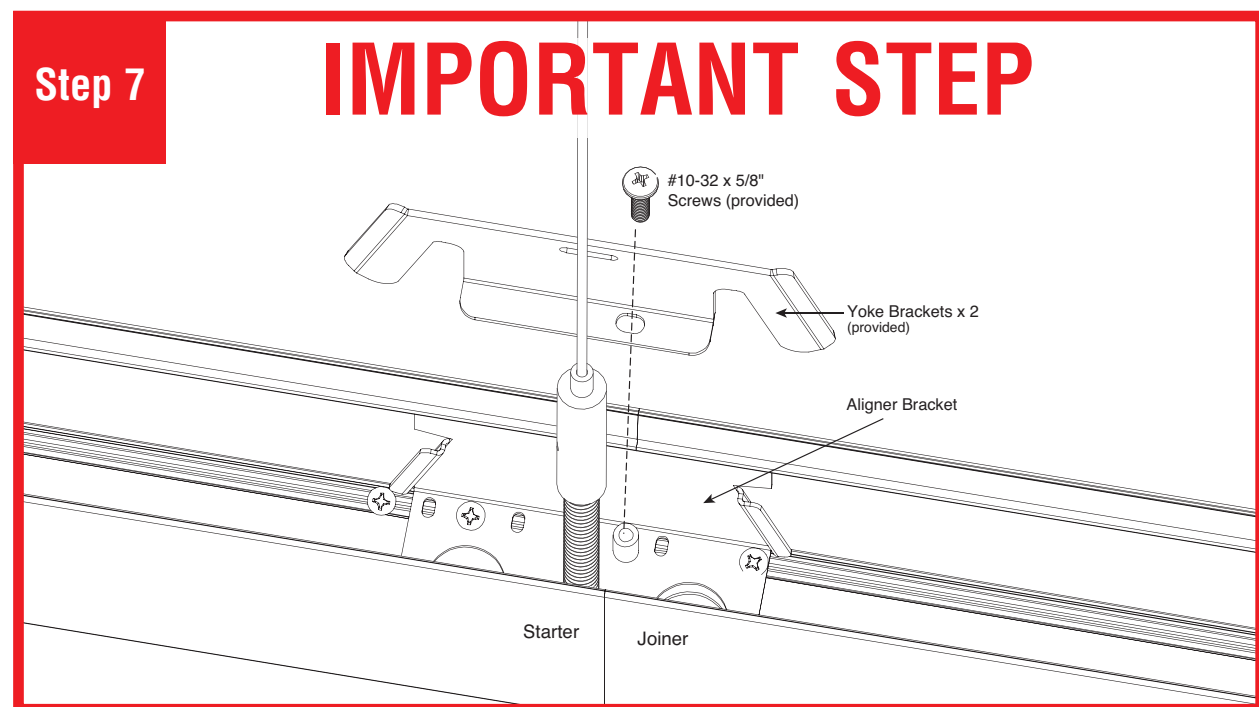

IMPORTANT STEP: Secure joint with two yoke brackets (provided) using #10-32 x 5/8" screws (provided).
CAUTION: When installed correctly these brackets will pull luminaires together to make a tight joint. Do not over-tighten.

Note: All power connections to be installed to local/national codes by a Certified Electrician.

HP-2 Indirect Joiner/Ender Installation Instructions

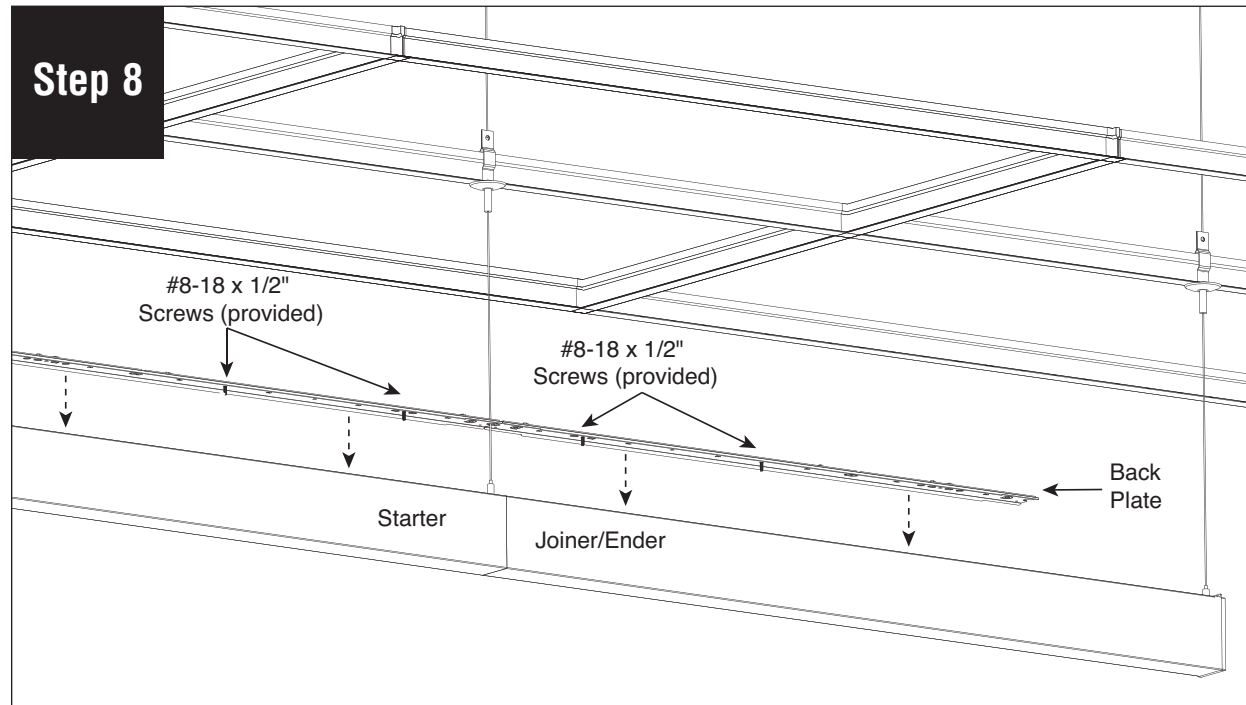

Reinstall back plates using the same #8-18 x 1/2" screws.

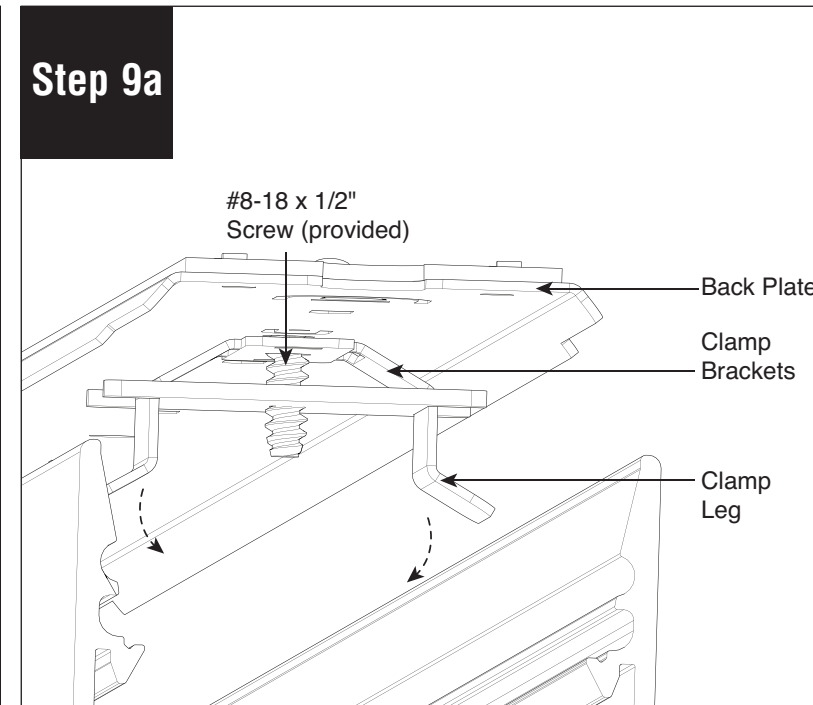

A. Squeeze together clamp legs slightly by hand to make sure that they clear the side walls.

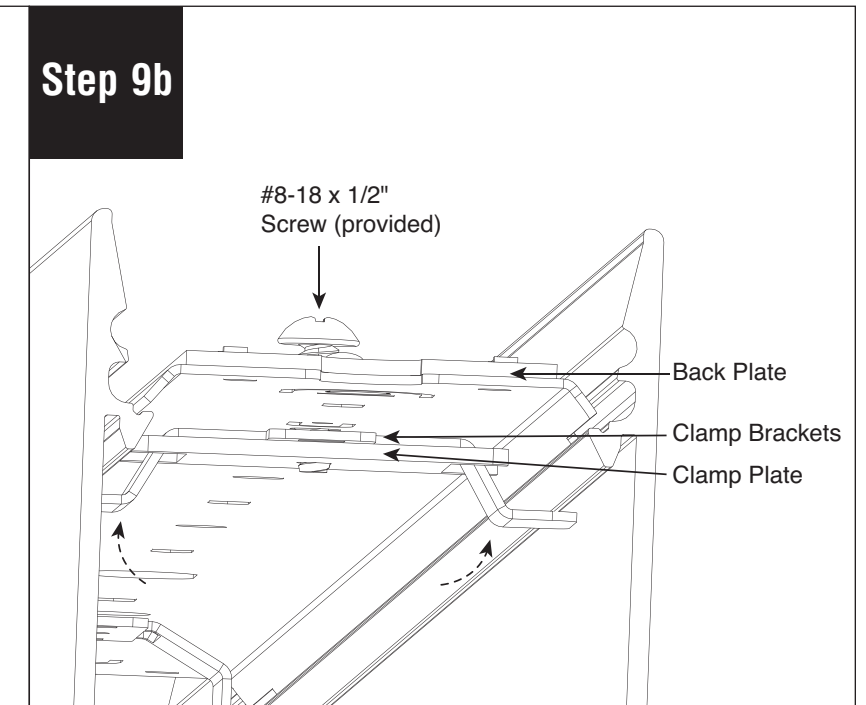

B. Insert assembly down into body. Tighten screw fully in order to clamp the legs tightly to the body.

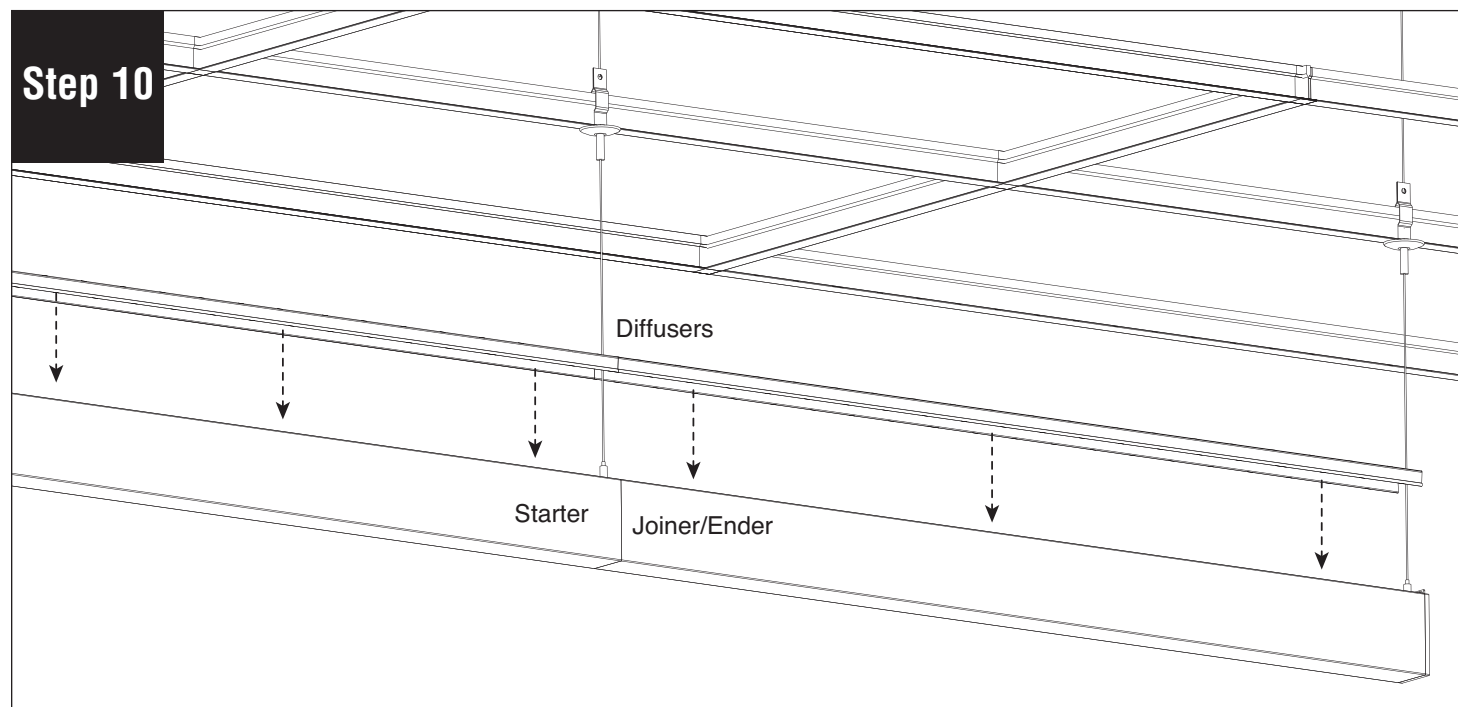

Reinstall diffusers and turn power on to luminaire.

Note: All power connections to be installed to local/national codes by a Certified Electrician.