

# HP-2 Flush Diffuser Surface Mount Drywall Starter/Independent Installation Instructions

Scan QR code for helpful video(s)

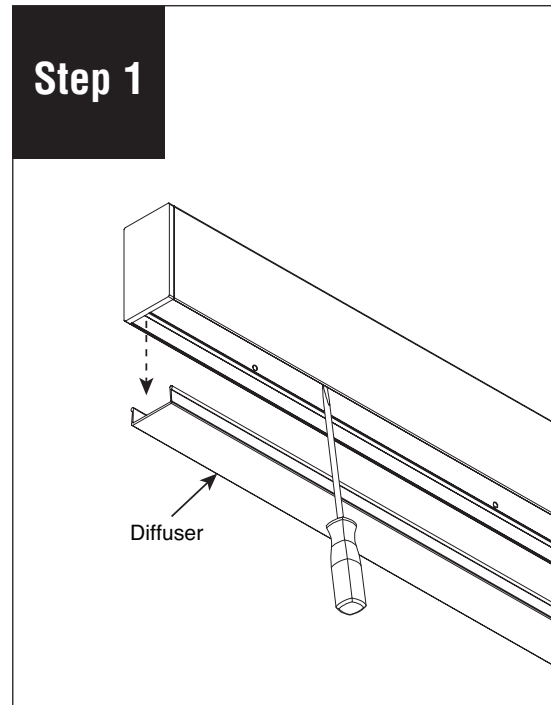

0 - 10V Dimming



Remove diffuser and set aside to prevent it from getting dirty or damaged.

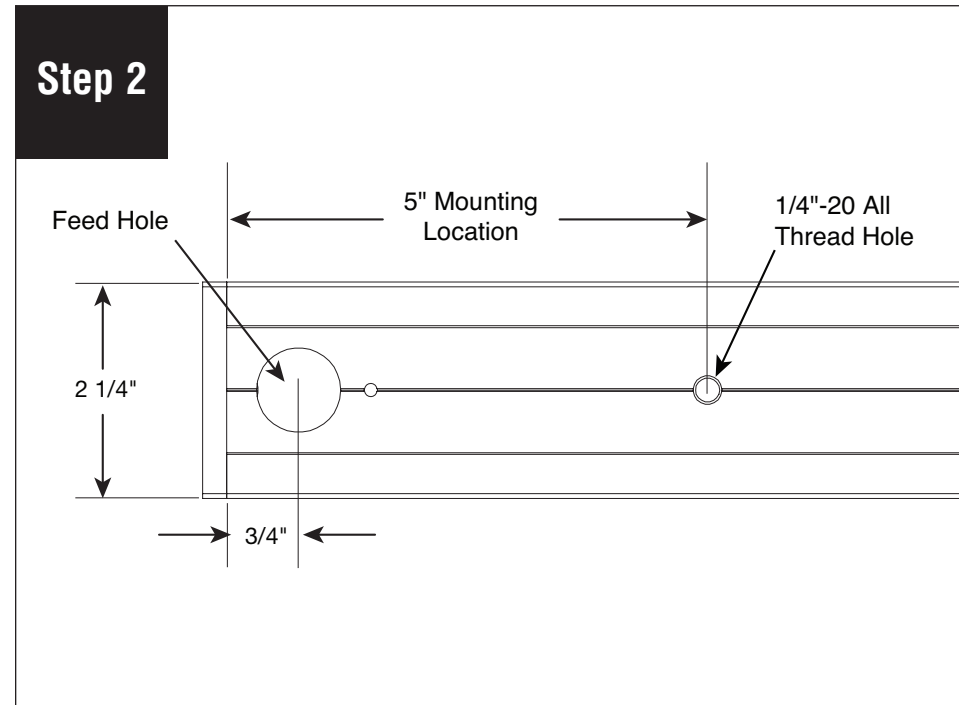

Note feed hole on luminaire as indicated above.

**Step 3**

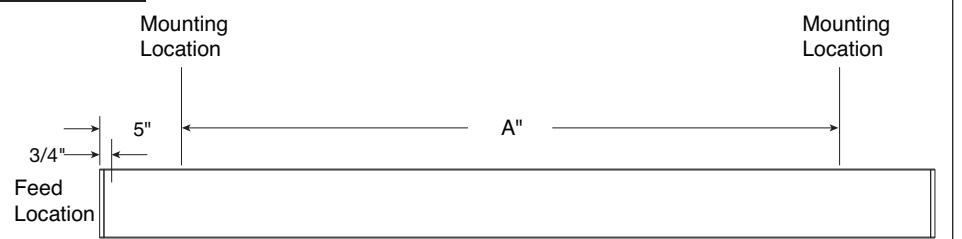

Mounting Location

Mounting Location

3/4"

5"

A"

Feed Location

MOUNTING HOLE LOCATION TABLE	
LUMINAIRE LENGTH	'A'
4'	38"
8'	86"
12'	134"

Use the chart above to determine the correct mounting points. Provide structural blocking at each mounting location (by others).

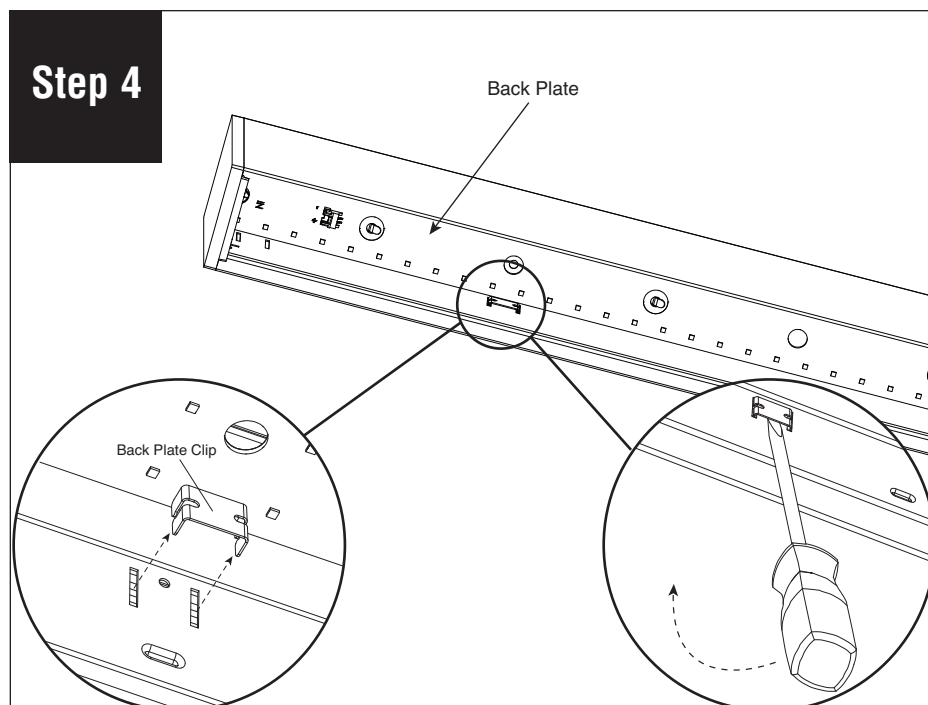

Remove back plate clips (provided) to release back plate. We recommend using a flat head screwdriver to get them loose. **CAUTION: Do not lose these pieces.**

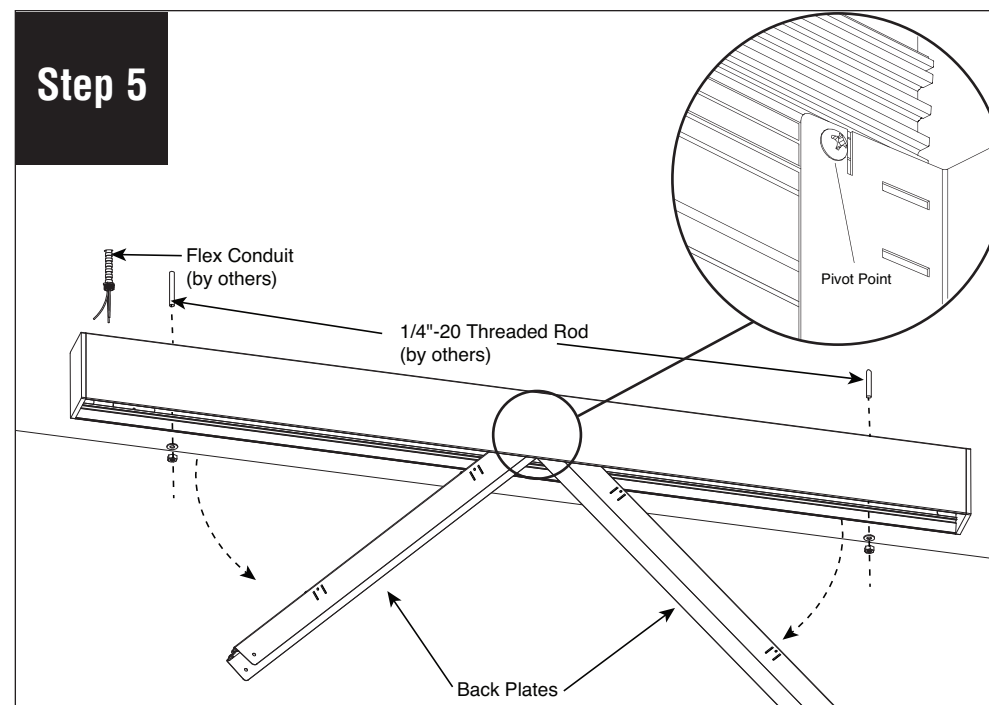

Slowly swing down back plates. **CAUTION: Do not twist back plates when swinging down – it will come out of the support extrusion.** Install luminaire on to drywall ceiling.

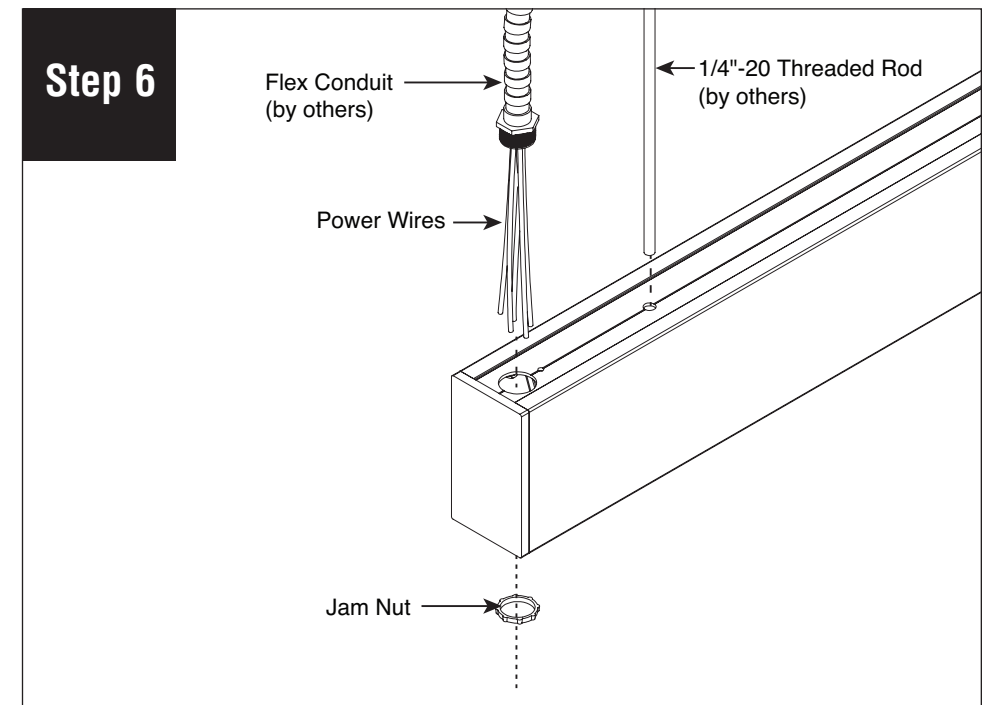

Insert wires through jam nut and install jam nut onto conduit connector.

**Note:** All power connections to be installed to local/national codes by a Certified Electrician.

# HP-2 Flush Diffuser Surface Mount Drywall Starter/Independent Installation Instructions

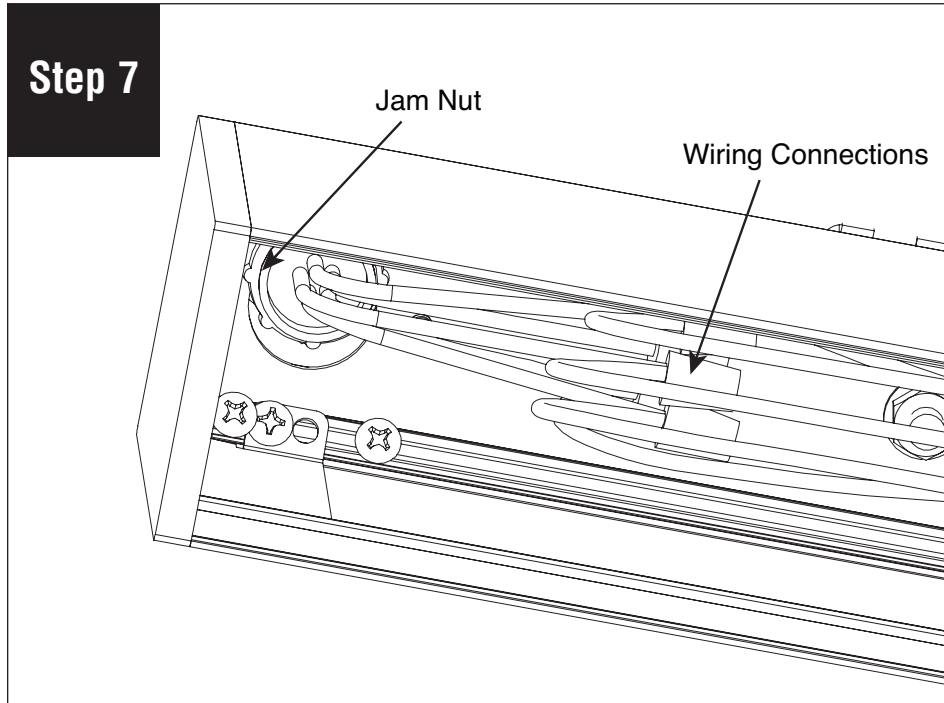

Make wiring connections.

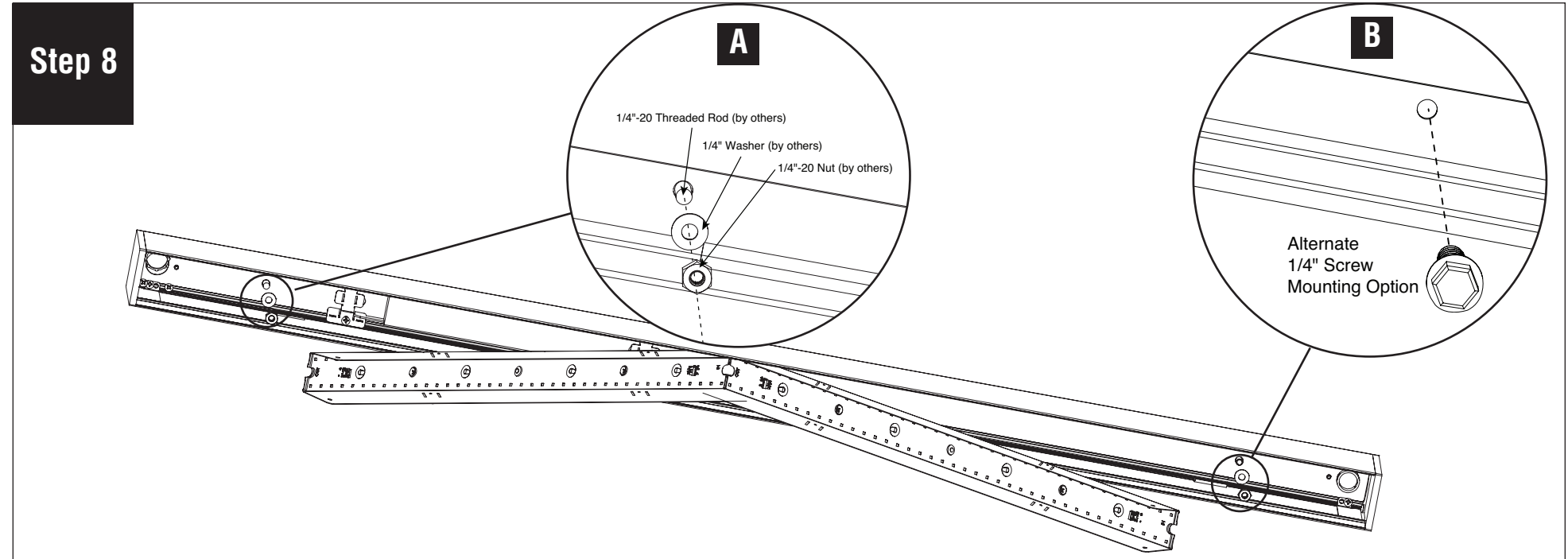

**A.** Install 1/4" washers (by others) and 1/4"-20 nuts (by others) onto 1/4"-20 threaded rod (by others). **B.** Alternate mounting option - Install 1/4" screw (by others) through mounting hole into proper structurally supported blocking (by others).

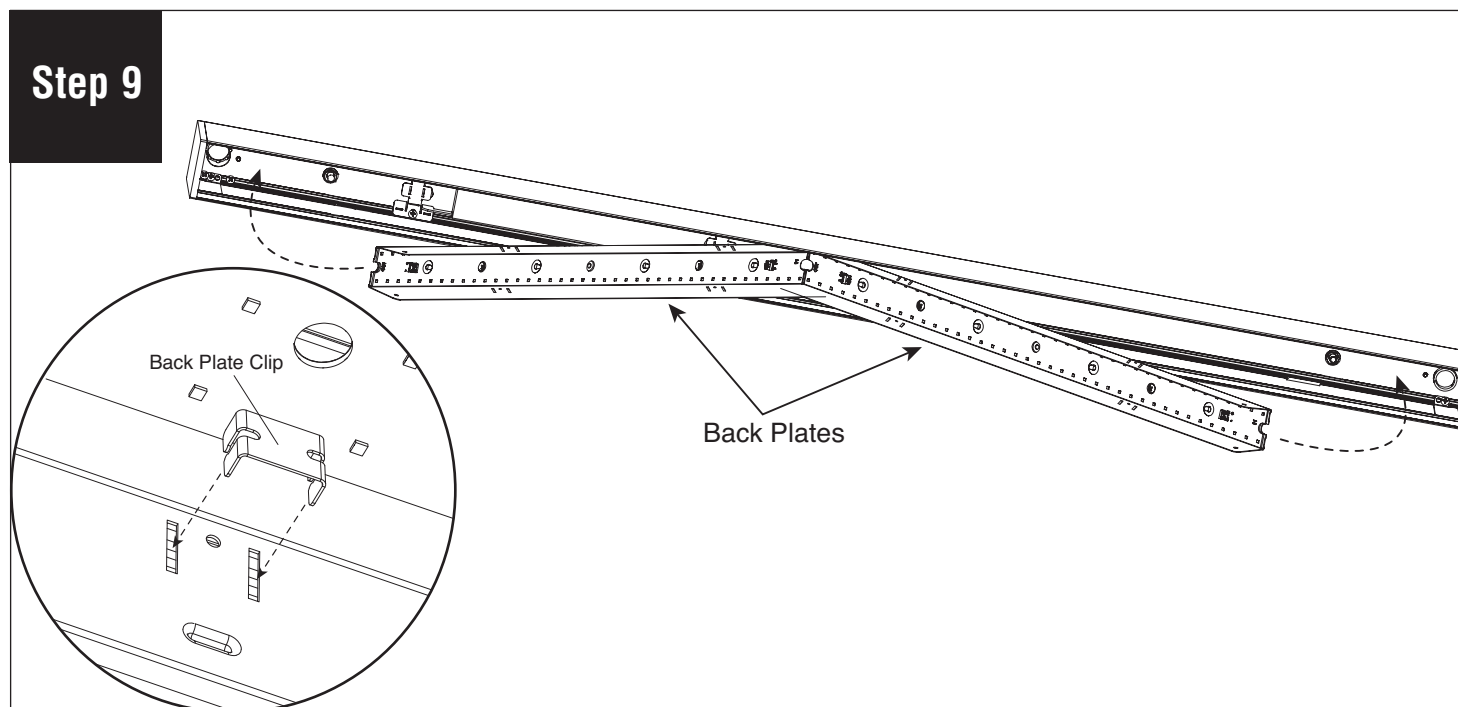

Replace back plates by holding them in their original position and pushing the clips back in. Make sure wire connections are not pinched. (If 1 ft. back plate assembly is near joint, reconnect feed harness to LED board).

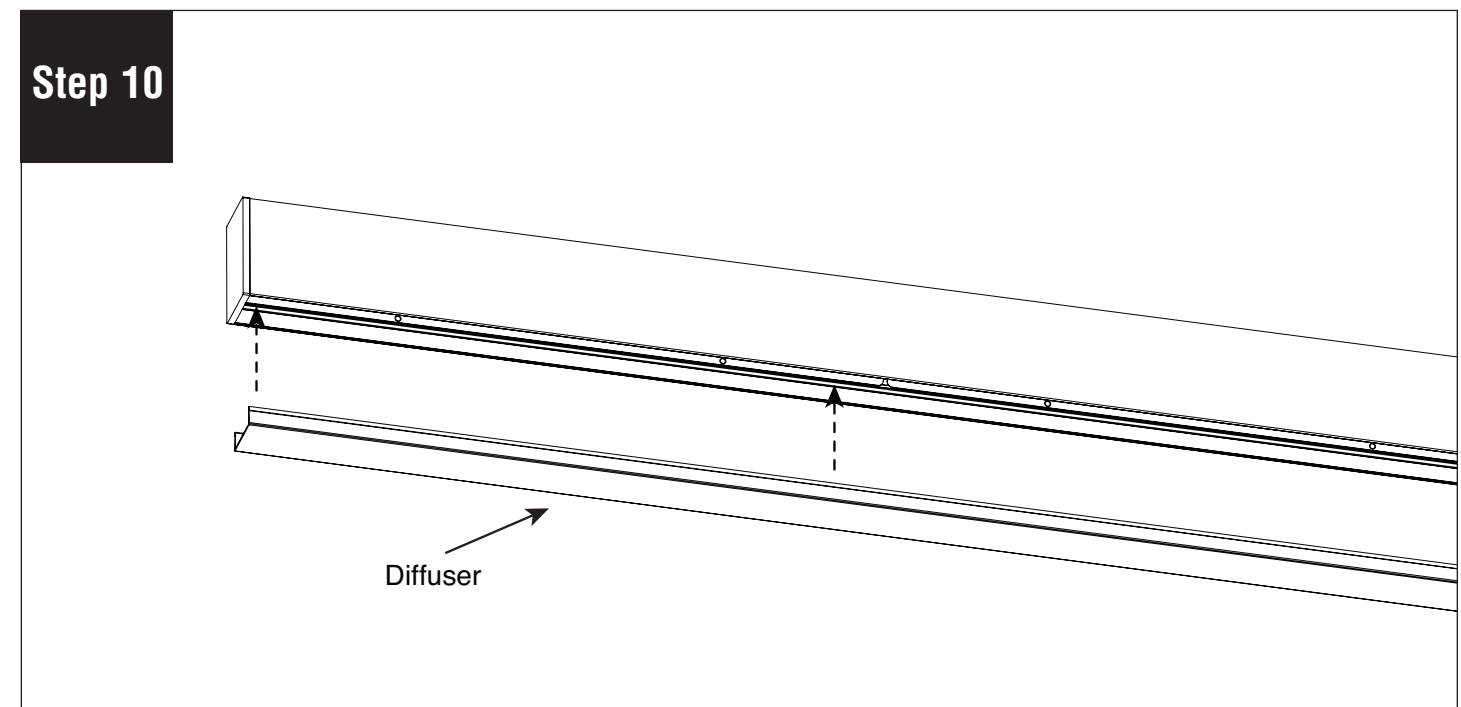

Reinstall diffuser and turn power on to luminaire.

**Note:** All power connections to be installed to local/national codes by a Certified Electrician.

# HP-2 Flush Diffuser Surface Mount Drywall Joiner/Ender Installation Instructions

Scan QR code for helpful video(s)



0 - 10V Dimming

### Step 1

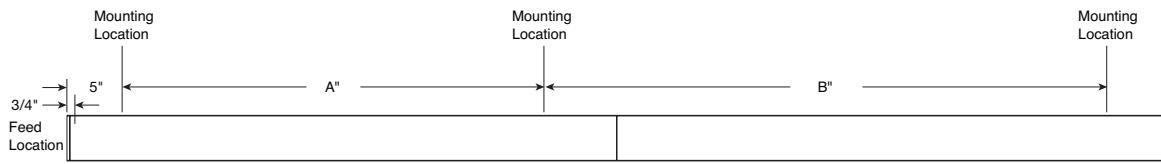

MOUNTING HOLE LOCATION TABLE		
LUMINAIRE LENGTH	'A' (IN)	'B' (IN)
4'	38"	48"
8'	86"	96"
12'	134"	144"

Use the chart above to determine the correct mounting points. Secure luminaire to structure using tie-wire (by others) according to code.

### Step 2

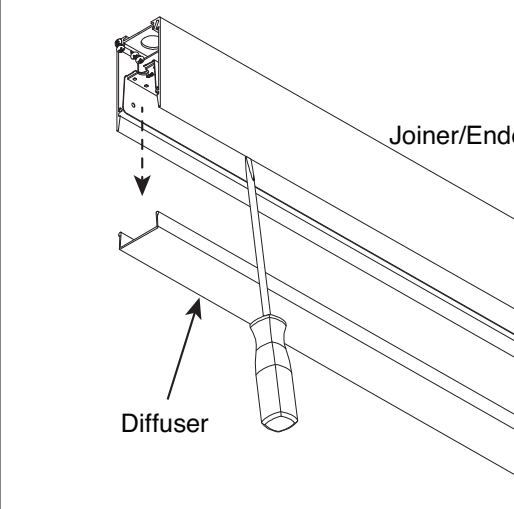

Remove diffuser and set aside to prevent it from getting dirty or damaged.

### Step 3

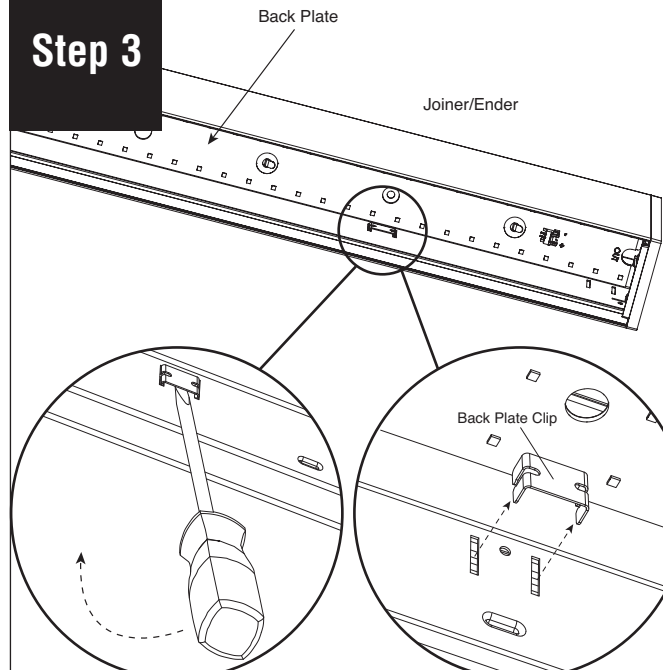

Remove back plate clips (provided) to release back plate. We recommend using a flat head screwdriver to get them loose. **CAUTION: Do not lose these pieces.**

### Step 4

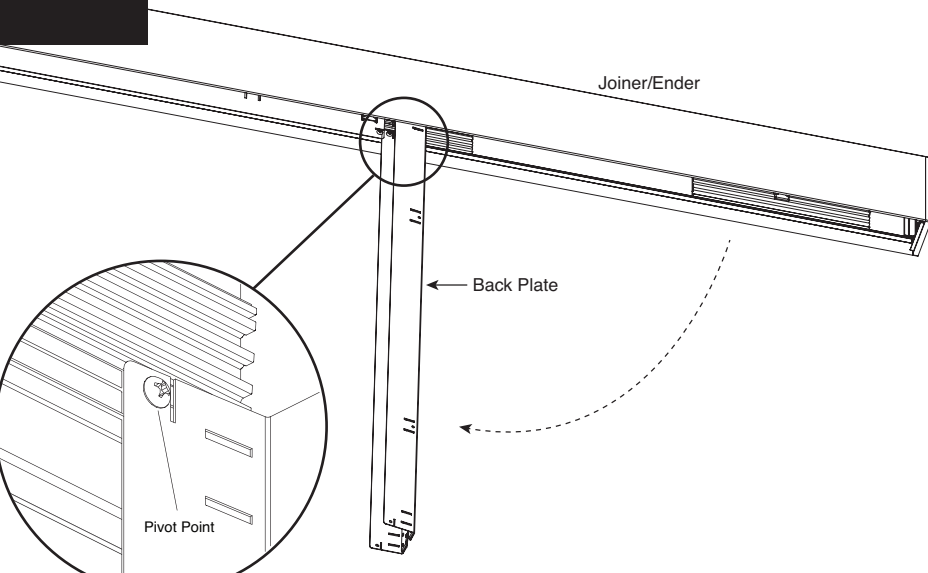

Slowly swing down back plate at the end of the luminaire. **CAUTION: Do not twist back plate when swinging down – it will come out of the support extrusion.**

### Step 5

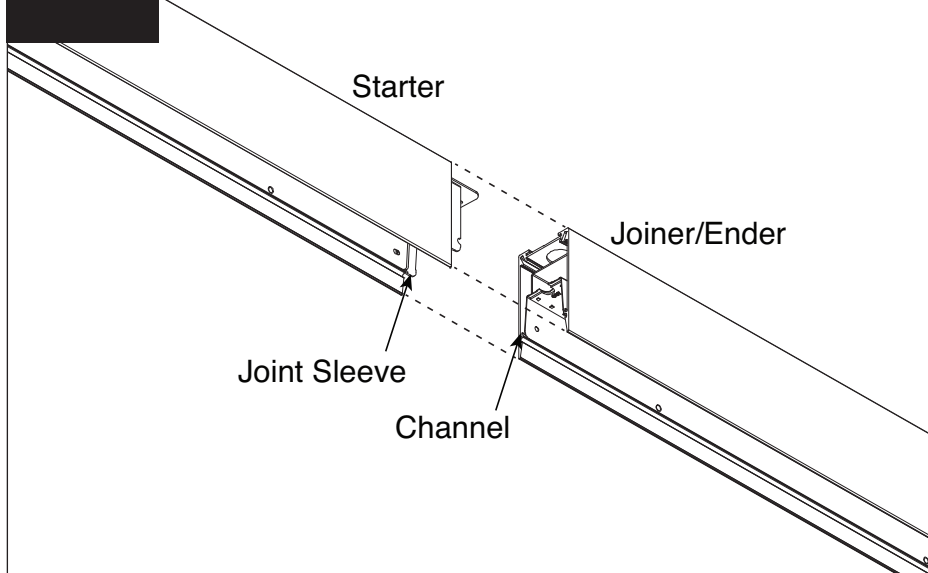

Slide joiner/ender onto starter luminaire. Align joint sleeve with channel.

### Step 6

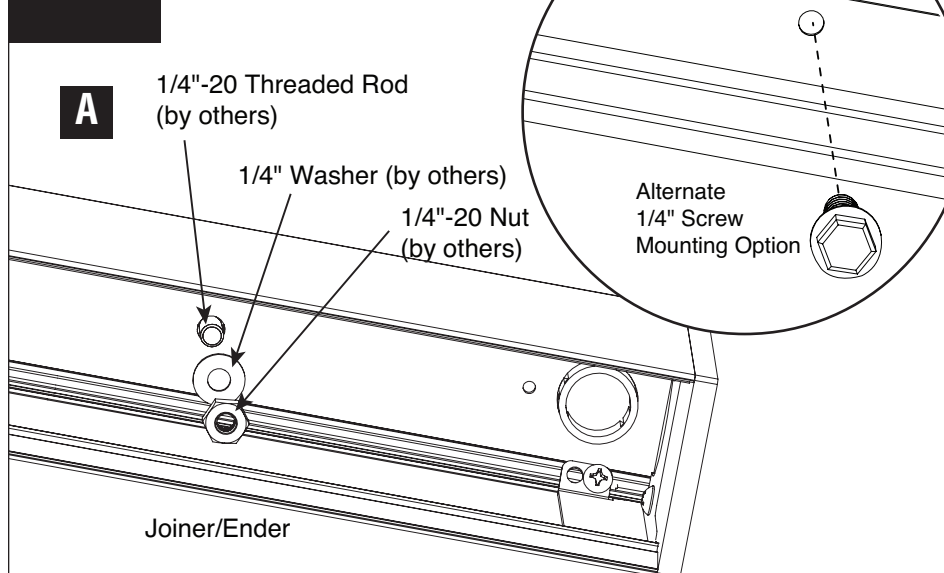

**A.** Install 1/4" washers (by others) and 1/4"-20 nuts (by others) onto 1/4"-20 threaded rod (by others) at the end of luminaire. **B.** Alternate Option - Install screw (by others) through mounting hole into proper structurally supported blocking (by others).

**Note:** All power connections to be installed to local/national codes by a Certified Electrician.

# HP-2 Flush Diffuser Surface Mount Drywall Joiner/Ender Installation Instructions

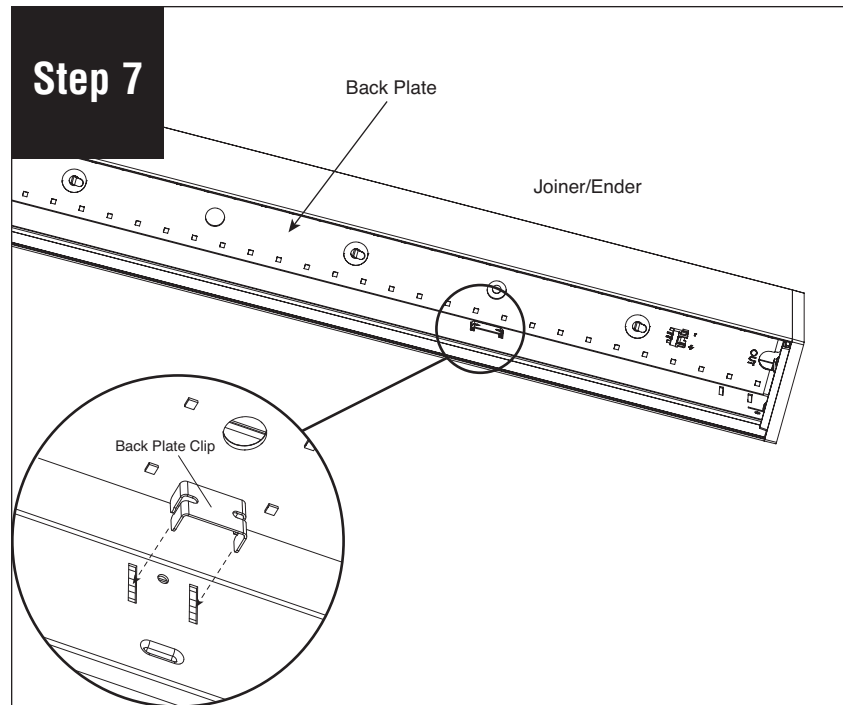

Replace back plate at end of luminaire by holding it in the original position and pushing the clips back in.

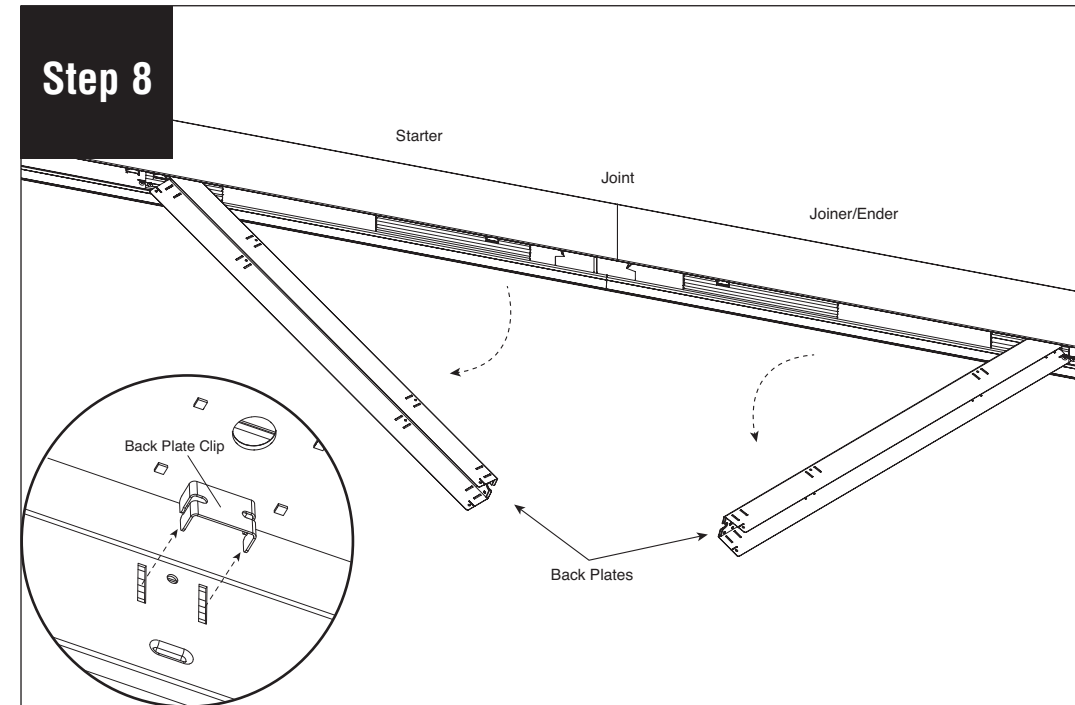

Remove back plate clips at the joint of both luminaires and slowly swing down back plates.

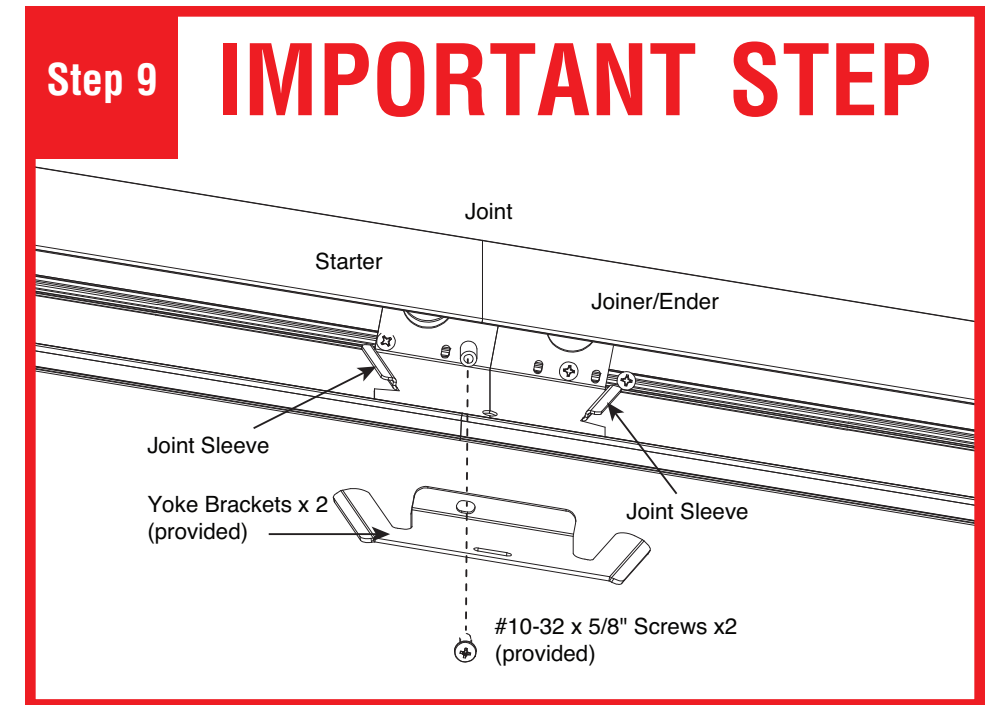

**IMPORTANT STEP:** Secure joint with two yoke brackets (provided) using #10-32 x 5/8" screws (provided). **CAUTION:** When installed correctly these brackets will pull luminaires together to make a tight joint. Do not over-tighten.

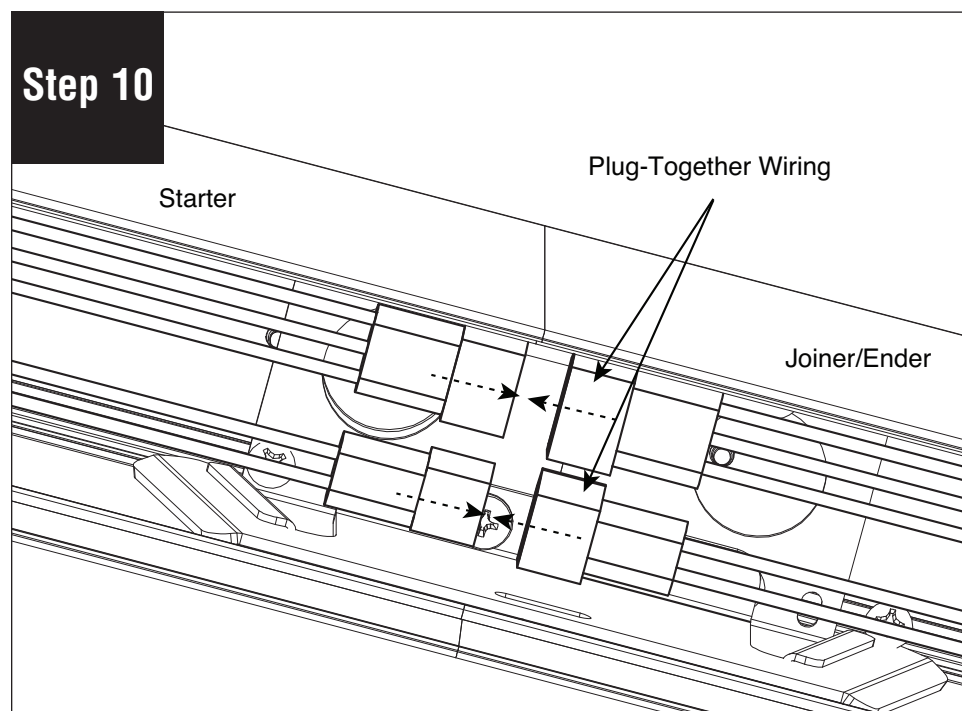

Connect plug-together wiring.

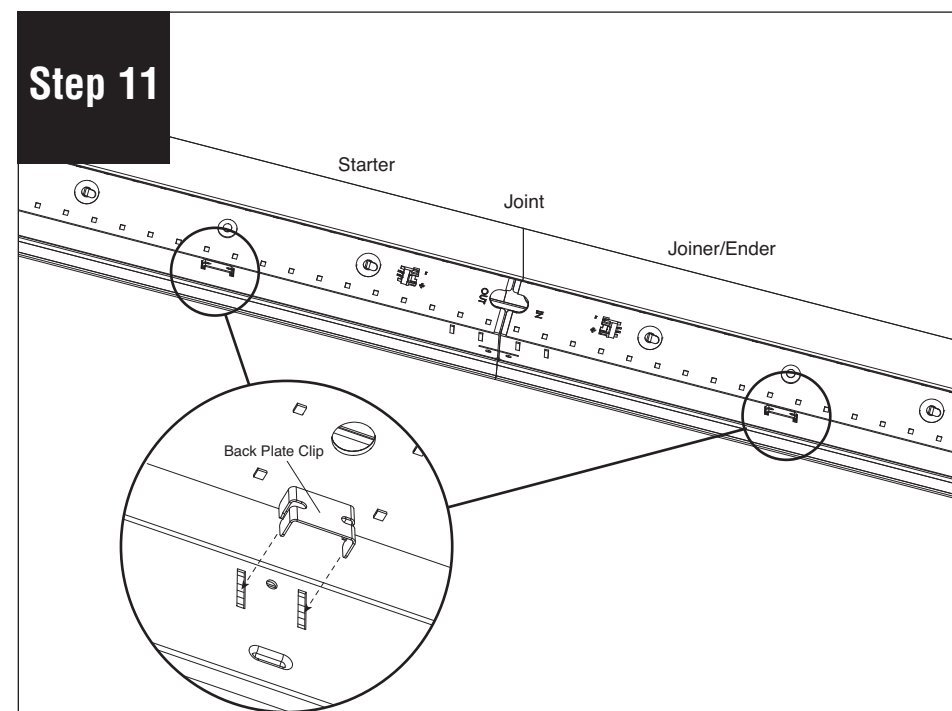

Replace back plates by holding them in their original position and pushing the clips back in. Make sure wire connections are not pinched. (If 1 ft. back plate assembly is near joint, reconnect feed harness to LED board).

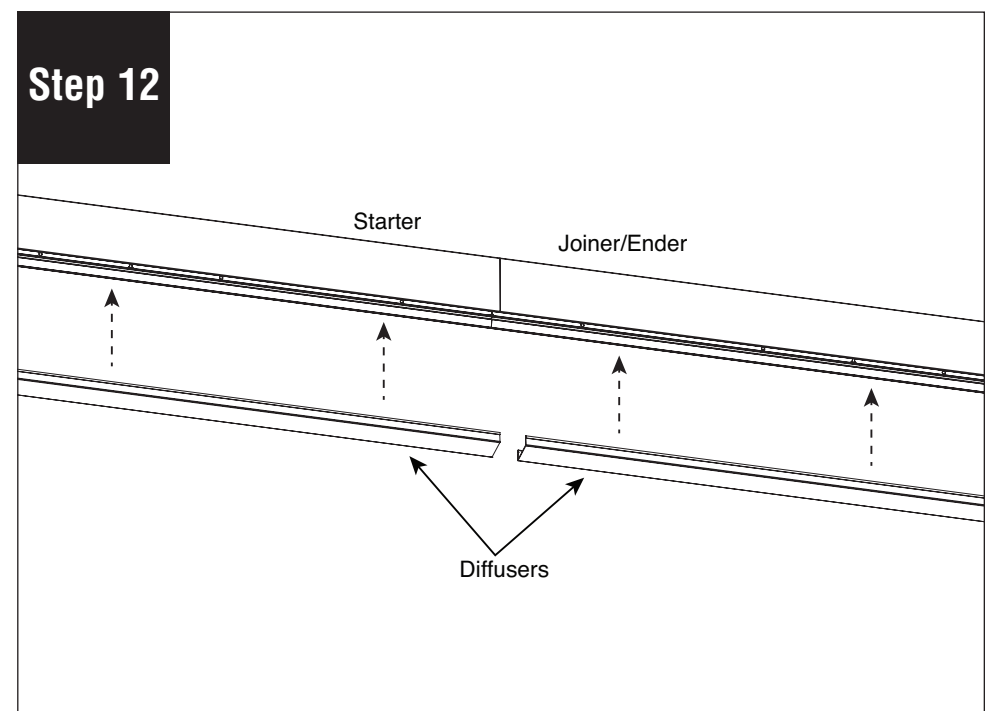

Reinstall diffusers and turn power on to luminaire.

**Note:** All power connections to be installed to local/national codes by a Certified Electrician.